

Air Hoist Transporter

For Monorail Air Chain Hoists
Hoist Capacities From 25t to 60t

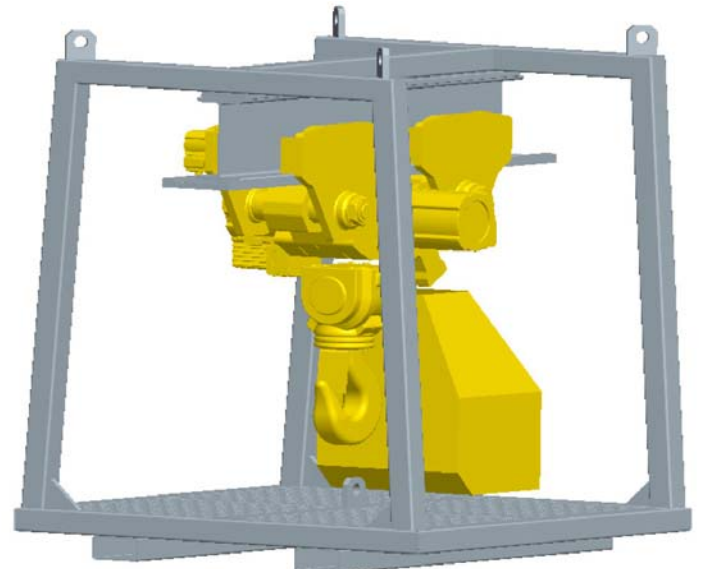
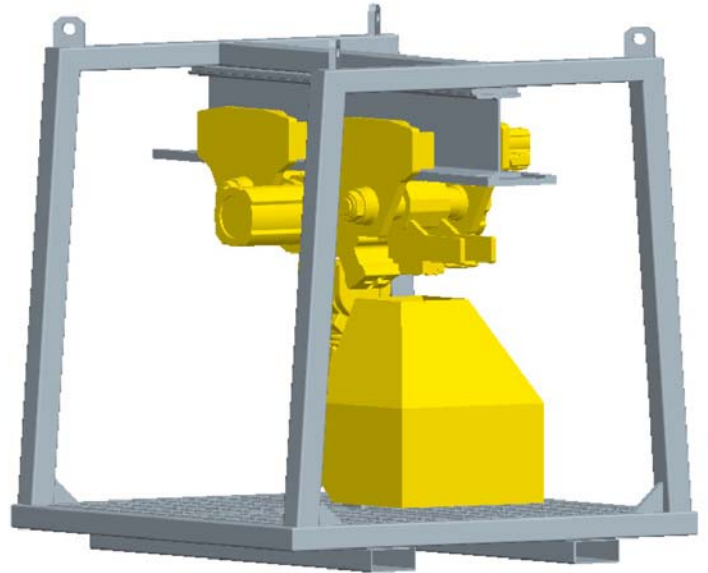
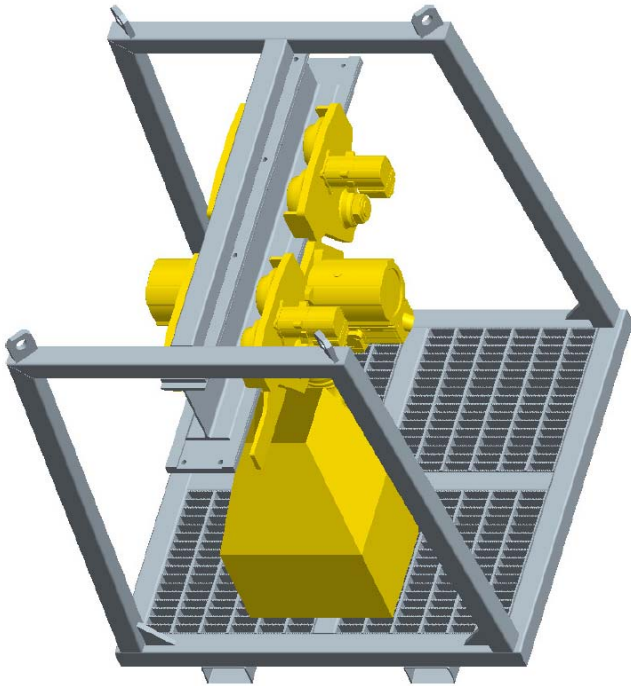

Features

- Eliminates damage to hoist during shipment and transportation
- A loaded transporter can be packed into a conventional Conex Box by forklift or with a crane
- Four lift points for moving with a crane
- Forklift slots for 2-way entry
- Monorail beam is bolted to the transporter allowing for detachment
- Hot dipped galvanized
- Adaptable for wide range of flange widths
- Each unit is serialized with data tag for reference to certificate documentation
- Each unit equipped with four-leg bridle, with certificates
- Dimensions
 - Footprint - 72in x 72in
 - Height - 86in
- Empty weight - 1,400 lbs