

Telescoping Joint Assembly

Parts List: Telescoping Joint Assembly
P/N 694240-01 SD-TJ-145

ITEM	PART NO.	QTY.	DESCRIPTION
1	694243-01	1	SEAL SUB ASSEMBLY
2	694244-01	1	UPPER HOUSING SUB ASSEMBLY
3	694076	1	TENSIONING RING
4	688999-06	1	INNER BARREL WELDMENT
5	694239-02	1	OUTER BARREL WELDMENT
6	694242-01	1	FEMALE RISER CONNECTOR HARDWARE
8	21797-16	1	GASKET, 25" O.D., 23-1/2" I.D. X 1/4" THICK
9	18542-19	20	CAP SCREW, 1-1/4" 8UN -3.5" LONG

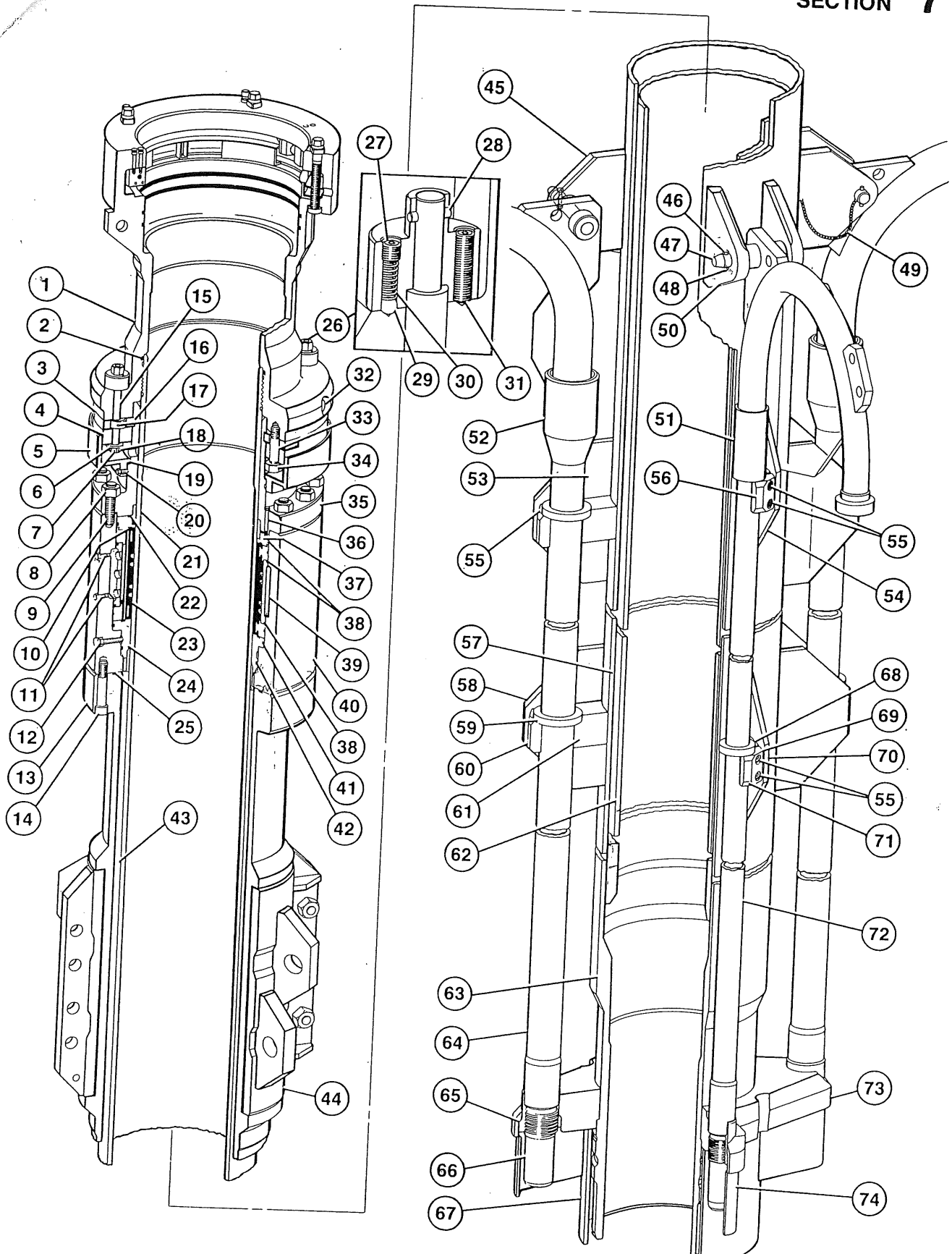

**Upper Housing and Seal Subassemblies
And Outer Barrel Weldment**

P/N 694244-01 P/N 694243-01 P/N 694239-02

SD-SA-146

Parts List: Telescoping Joint Upper Housing and Seal Subassemblies and Outer Barrel Weldment
P/N 694244-01, P/N 694243-01, P/N 694239-02 SD-SA-146

ITEM	PART NO.	QTY.	DESCRIPTION
1	694777-01	1	UPPER END CONNECTION, TELESCOPING JOINT
2	30101-96-18-80	1	"O" RING, 21-3/8" X .275"
3	688977-02	1	LOCKING SEGMENT SET
4	688978-02	1	HOUSING, LOCKING SEGMENT
5	688979-02	1	LUBRICATION RESERVOIR
6	7799-60	4	WASHER, 3/4"
7	700397	4	LOCK NUT, HEX HEAVY DUTY FULL .750 - 10UNC STL CD PL FLEX LOC
8	5926-23-10	20	NUT, 1-1/4" - 8UN
9	5915-67-10	20	STUD, 1-1/4" - 8UN X 5-1/4" LG
10	21797-18	2	GASKET, 23-5/8" O.D. X 22-1/4" I.D. X 1/4"
11	5930-03	2	1/2" HEX HEAD PIPE PLUG
12	35372-28	4	HEX HEAD CAP SCREW 1/2 - 13NC X 2-1/2" LG
13	686301-03	1	FLANGE
14	18542-19	20	CAP SCREW, 1-1/4" - 8 X 3.5"
15	686562-02	4	SHAFT
16	686561	4	CAM
17	21810-71	4	PIN, DOWEL, 1/4 DIA. X 1-11/16" LG
18	6006-07	4	COTTER PIN, 1/8" X 1-3/4" LG
19	21797-17	1	GASKET, 23-5/8" O.D. X 23" I.D. X 1/8" THK
20	702501-10-00-12	4	CAP SCREW, 1/2 - 13NC - 2 X 1-1/4" LG
21	688990-02	1	SPLIT WEAR BUSHING
22	21797-18	1	GASKET, 23-5/8" O.D. X 22-1/4" I.D. X 1/4" THK
23	688993-02	1	SPLIT SEAL ASSEMBLY
24	688994-02	1	LOWER THRUST RING
25	21797-16	1	GASKET, 25 O.D. X 23.5 I.D. X .25" THK
26	686563	4	ACTUATOR
27	702514-27-10-08	4	SET SCREW, 5/8 - 11UNC - 3 X 5/8" LG
28	21810-72	4	PIN, DOWEL, 1/4 DIA. X 1-7/32" LG
29	6039-29	4	STEEL BALL, 1/2"
30	5957-66	4	COIL SPRING, 1/2" O.D. X 1-1/4" LG 7 COILS
31	702514-27-21-14	4	SET SCREW, 5/8 - 11 - 3A X 1-7/8" LG
32	692583-03	4	BOLT, LOCK, HEX HEAD, 3/4 - 10UNC - 2A X 4-15/16"
33	38732-61-00-64	12	STUD, 1-1/2 - 8UN X 6-1/2" LG
34	5926-26	12	NUT, 1-1/2 - 8UN
35	688995-02	1	UPPER FLANGE
36	702522-06-00-33	4	12 PT CAP SCREW, 3/8 - 16UNC X 3-3/8" LG
37	688991-02	1	UPPER THRUST RING
38	30101-60-18-80	3	"O" RING, 25" O.D. X .275"
39	688992-02	1	SUPPORT SLEEVE, SEAL
40	688996-02	1	SEAL HOUSING
41	30101-60-18-80	1	"O" RING, 25" O.D. X .275"
42	18493-55	1	"O" RING, 23" O.D. X .500"
43	691181-04	1	TENSIONING SWIVEL ADAPTER
44	694076	1	TENSIONING RING
45	694237-04	2	SUPPORT GUIDE

Parts List: Telescoping Joint Upper Housing and Seal Subassemblies and Outer Barrel Weldment

P/N 694244-01, P/N 694243-01, P/N 694239-02 SD-SA-146

ITEM	PART NO.	QTY.	DESCRIPTION
46	702501-10-00-24	3	CAP SCREW
47	691175-01	3	PIN
48	5926-05-10	3	NUT
49	693310-10	3	LINK CHAIN
50	694237-01	2	SUPPORT GUIDE
51	694238-01	1	UNION FEMALE HALF, HYDRAULIC LINE
52	693295-01	2	UNION FEMALE HALF, CHOKE AND KILL LINE
53	686339-02	4	PROTECTIVE GUSSET
54	694241-01	2	GUSSET
55	702504-16-00-14	24	CAP SCREW
56	694235	2	CLAMP
57	674431-76	1	OUTER BARREL
58	686339-02	4	GUSSET
59	21818-36	4	STOP RING
60	687670	2	CLAMP
61	688972-02	2	SUPPORT BLOCK
62	688999-06	1	INNER BARREL WELDMENT
63	688973-02	1	ADAPTER
64	-	2	TUBING 3.500 O.D. X 2.500 I.D. C.I.W. CL 21
65	683544	2	SLEEVE
66	687923	2	MALE STAB SUB
67	688564-21-03	1	PIN PROTECTOR
68	694236	2	SUPPORT BLOCK
69	21818-45	1	STOP RING
70	694241-01	2	GUSSET
71	694235	2	CLAMP
72	-	1	TUBING HYDRAULIC LINE 2.875 O.D. X 2.328" I.D. C.I.W. CL 21
73	694228	1	PIN CONNECTOR
74	694234	1	MALE STAB
	694231	1	MALE STAB W/SLEEVE